

1 Installation dimensions for Eco-HK 130-230

1.1 Space requirements

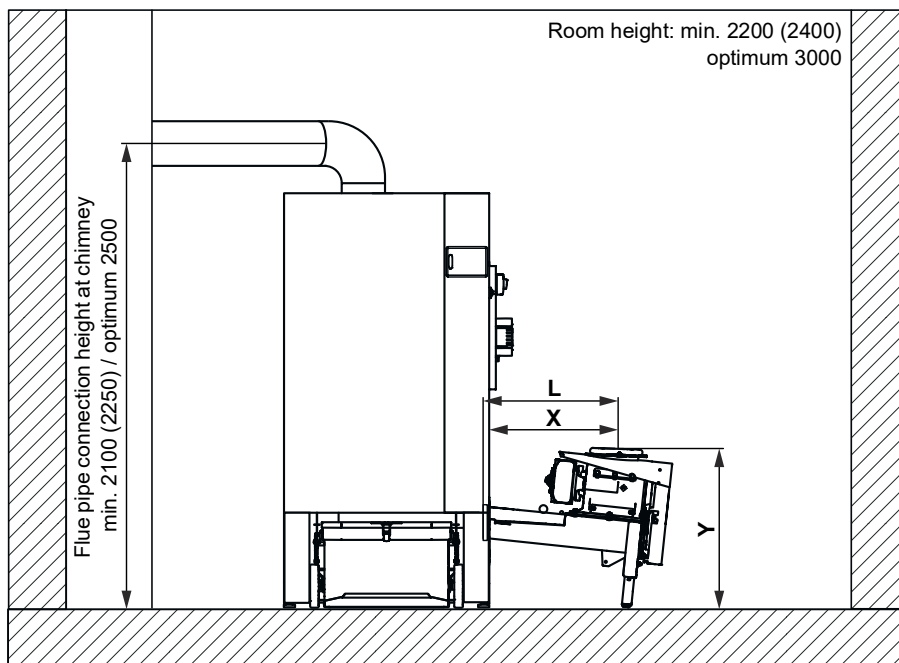
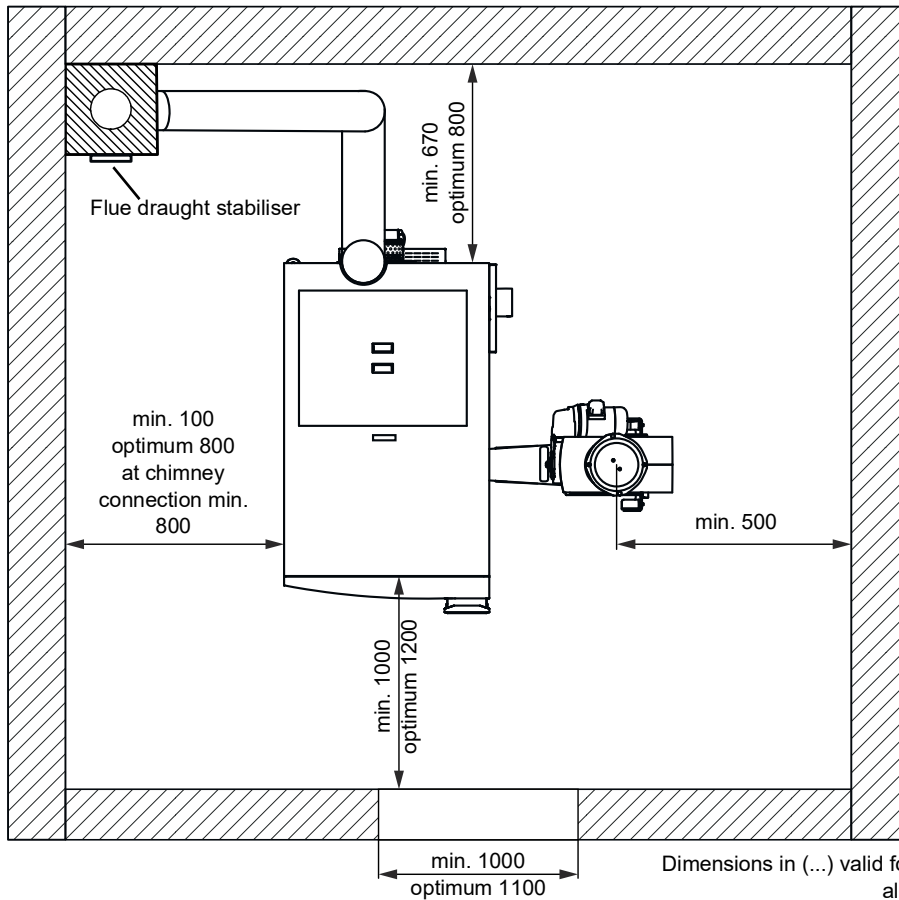

	Stoker unit length L			
	600 mm	1000 mm	1500 mm	2000 mm
Stoker depth X	585 mm	985 mm	1480 mm	1980 mm
Stoker height Y	730 mm	690 mm	635 mm	585 mm

1.2 Dimensioning

Dimensions in (...) valid for Eco-HK 200-230
all dimensions in mm

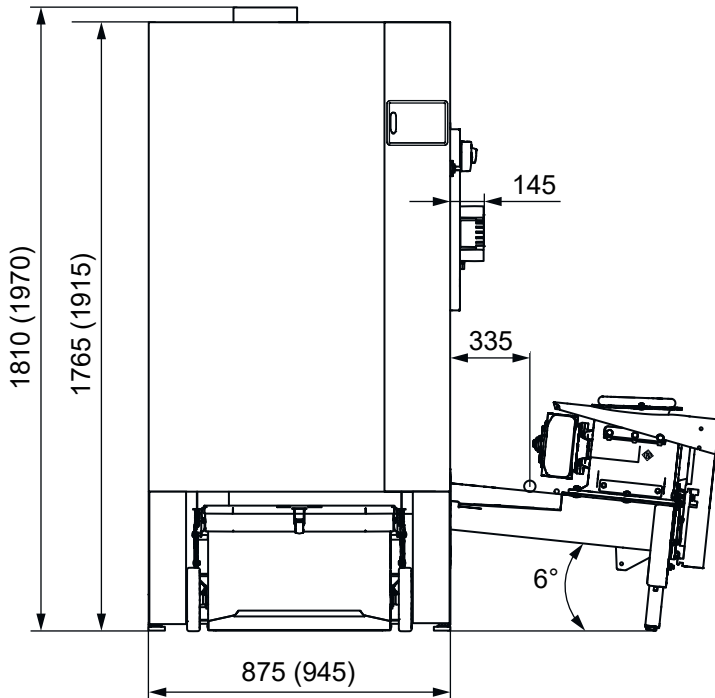

Boiler type

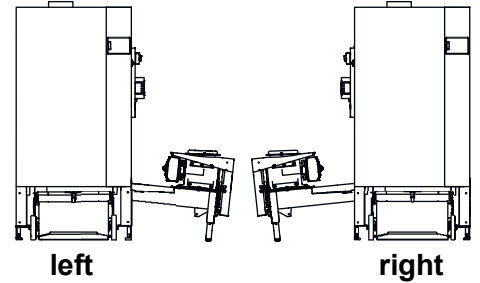
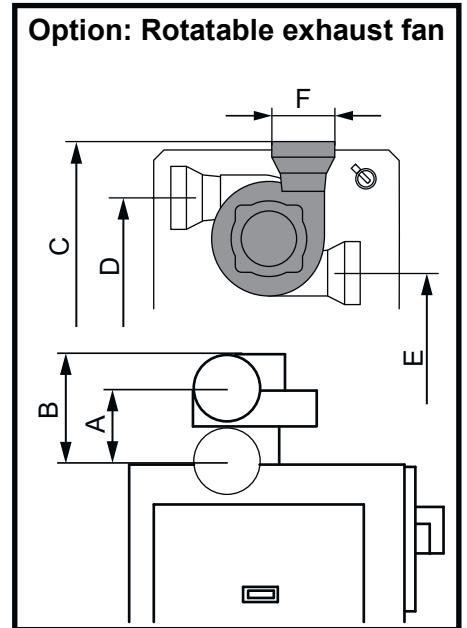
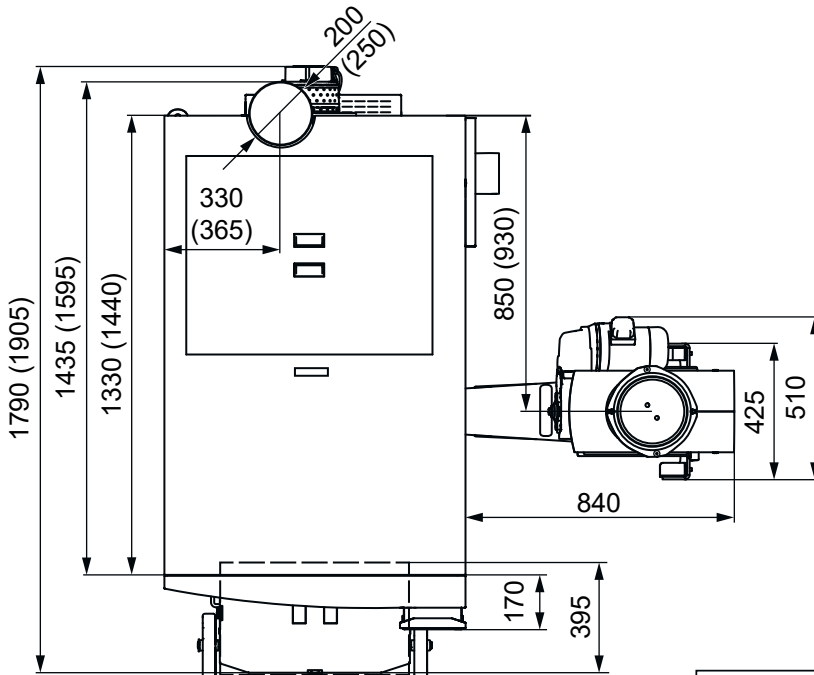

Image of Eco-HK 130-230 with standard stoker unit L = 600 mm



	A	B	C	D	E	F
Eco 130-170	225	325	1790	1535	1360	Ø200
Eco 200-230	300	425	1950	1685	1510	Ø250

Position D is not possible with a left boiler because the flue pipe would cover the flow.
Position E is not possible with a right boiler because the flue pipe would cover the return.

1.3 Connections

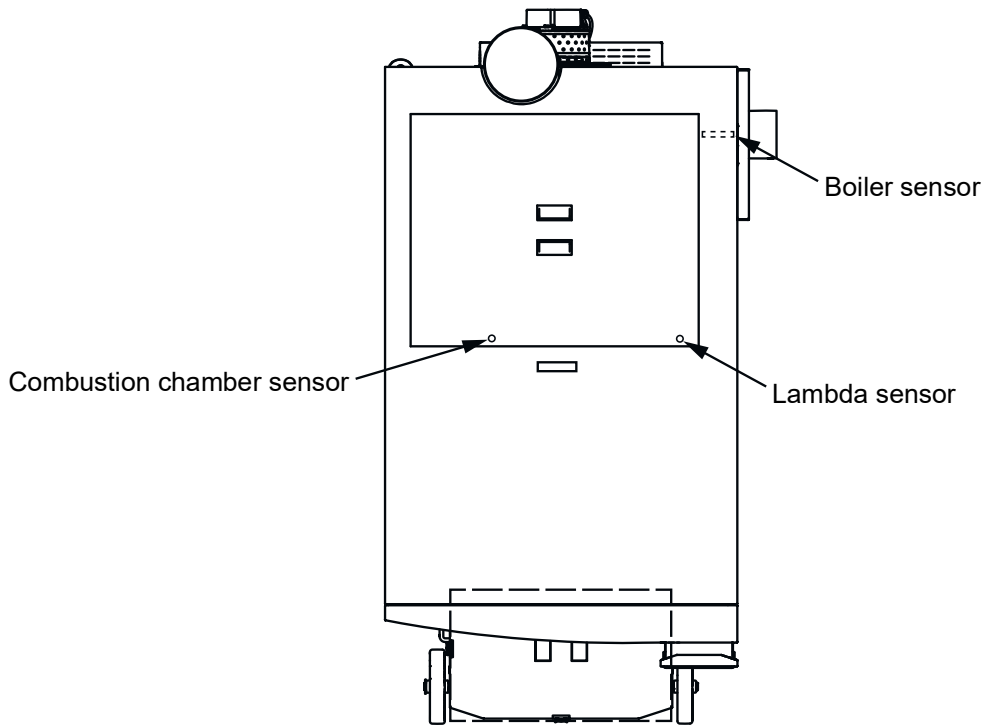
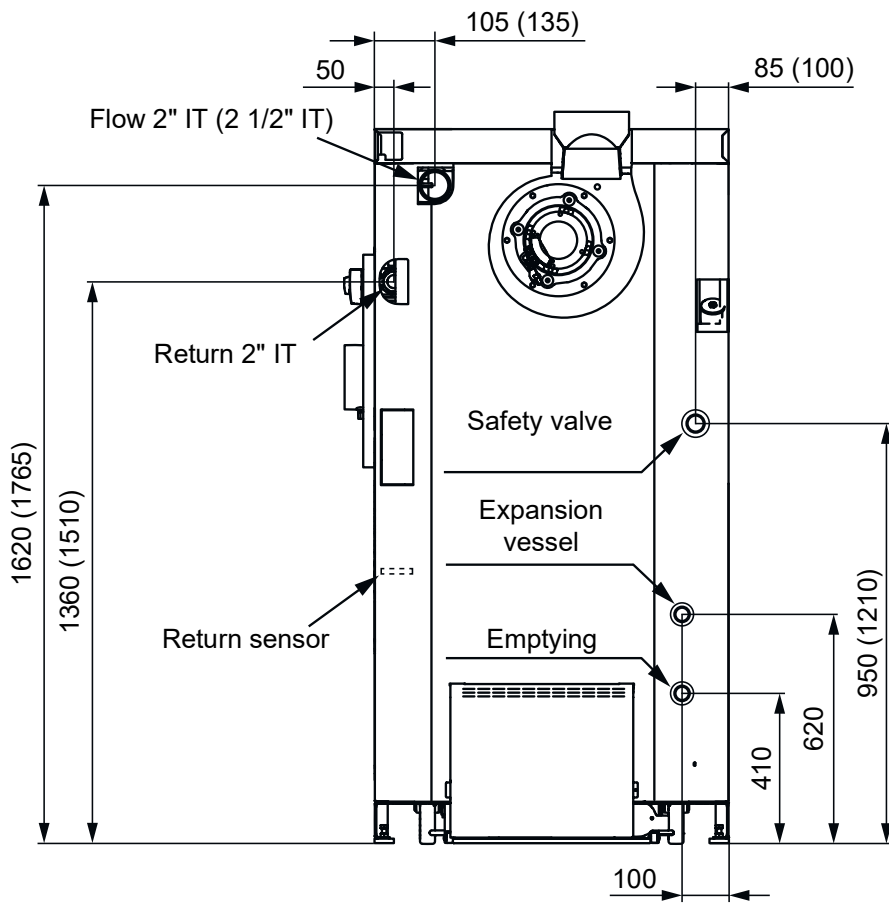

1.4 Technical data for Eco-HK 130-170

Designation	Unit	Eco-HK 130	Eco-HK 150	Eco-HK 170
Nominal heat output for wood chips/pellets	kW	39 - 130	44.7 - 149	49 - 166
Fuel heat output for wood chips/pellets	kW	137.3 / 139	157.3 / 158.8	175.7 / 176.2
Boiler class (according to ÖNORM EN 303-5:2012)		5		
Fuel and fuel class (according to EN ISO 17225)		Wood chips (A1-B1)/wood pellets (A1)		
Boiler height	mm	1765		
Boiler width	mm	875		
Boiler depth	mm	1790		
Transport dimensions (HxWxD)	mm	1810 / 875 / 1435		
FL connection height	mm	1620		
RL connection height	mm	1360		
Emptying	inches	3/4 IT		
Flow	inches	2 IT		
Return	inches	2 IT		
Expansion vessel connection	inches	3/4 IT		
Safety valve connection	inches	1 IT		
Permissible operating pressure	bar	3		
max. operating temperature	°C	95		
Water content	litres	253		
Weight	kg	1190		
Req. delivery pressure	Pa	5		
Flue draft max. limit	Pa	10		
Flue pipe diameter FPD	mm	200		
Flue gas temperature	°C	150		
CO ₂	%	14		
Flue gas mass flow rate	kg/sec	0.0754	0.0865	0.0965
Water-side resistance dT 10°	mbar	160.0	184.6	209.21
Water-side resistance dT 20°	mbar	42.7	49.0	55.5
Power consumption	W	186	224	266
Electric supply		400V AC, 50 Hz, 13 A		
Noise emissions (normal operation)*	dBA	57		

*Emission of airborne noise from the wood chip boiler in the boiler room; no significance for noise emissions at the chimney outlet or in the surrounding area

1.5 Technical data for Eco-HK 200-230

Designation	Unit	Eco-HK 200	Eco-HK 220	Eco-HK 230
Nominal heat output for wood chips/pellets	kW	59 - 199	59 - 216	67.8 - 226
Fuel heat output for wood chips/pellets	kW	210.8 / 210.1	229.1 / 228.3	239.9 / 238.9
Boiler class (according to ÖNORM EN 303-5:2012)		5		
Fuel and fuel class (according to EN ISO 17225)		Wood chips (A1-B1)/wood pellets (A1)		
Boiler height	mm	1915		
Boiler width	mm	945		
Boiler depth	mm	1905		
Transport dimensions (HxWxD)	mm	1970 / 945 / 1595		
FL connection height	mm	1765		
RL connection height	mm	1510		
Emptying	inches	3/4 IT		
Flow	inches	2 1/2 IT		
Return	inches	2 IT		
Expansion vessel connection	inches	3/4 IT		
Safety valve connection	inches	1 IT		
Permissible operating pressure	bar	3		
max. operating temperature	°C	95		
Water content	litres	360		
Weight	kg	1320		
Req. delivery pressure	Pa	5		
Flue draft max. limit	Pa	10		
Flue pipe diameter FPD	mm	250		
Flue gas temperature	°C	160		
CO ₂	%	14		
Flue gas mass flow rate	kg/sec	0.1158	0.1259	0.1317
Water-side resistance dT 10°	mbar	227	250	263
Water-side resistance dT 20°	mbar	63	69	72
Power consumption	W	324	330	334
Electric supply		400V AC, 50 Hz, 13 A		
Noise emissions (normal operation)*	dBA	56		

*Emission of airborne noise from the wood chip boiler in the boiler room; no significance for noise emissions at the chimney outlet or in the surrounding area