



ASSEMBLY AND MAINTENANCE INSTRUCTIONS

DirtOUT[®] XL

ISTRU000HCE-EN.05



MULTIFUNCTIONAL MAGNETIC DIRT SEPARATOR

Prodotto	Codice	Misure
DirtOUT XL (without ball valve)	DF00110034	3/4" F x 3/4" F
DirtOUT XL (without ball valve)	DF00110100	1" F x 1" F
DirtOUT XL (without ball valve)	DF00110022	ø22 x ø22
DirtOUT XL (without ball valve)	DF00110028	ø28 x ø28
DirtOUT XL (without ball valve)	DF00110100MM	1" F x 1" F
DirtOUT XL (DUAL MODE)	DF00120114	1" 1/4 F x 1" 1/4 F
DirtOUT XL (with ball valve)	DF00100034	3/4" F x 3/4" F
DirtOUT XL (with ball valve)	DF00100100	1" F x 1" F
DirtOUT XL (with ball valve)	DF00100114	1" 1/4 F x 1" 1/4 F
DirtOUT XL (with ball valve)	DF00100022	ø22 x ø22
DirtOUT XL (with ball valve)	DF00100028	ø28 x ø28

REQUIREMENTS AND WARNINGS



Carefully read the instructions in this manual before installing or performing maintenance of the component. Keep the manual in a safe place for future reference.



WARNING: Magnetic field. Never position the magnet in the vicinity of pacemakers, electromedical devices, general electronic equipment, magnetic cards etc., as it may damage them or interfere with operation.



WARNING: High temperature fluid. Risk of burns. Before installation and maintenance operations, ensure that the circuit water is at ambient temperature.

To install DirtOUT® XL, contact a qualified plumber authorised to issue an approved Declaration of Conformity.

COMPONENTS (see fig. 1)

- A) Upper cover
- B) Body
- C) Cyclonic insert (patented)
- D) Drainage valve (for routine cleaning)
- E) Magnet
- F) Air vent
- G) Mesh strainer support
- H) Mesh filter: 500 µm for the first cleaning of the system (preassembled), or 800 µm in the package
- I) Plastic inlet/outlet tee (only for DF100 model)
- J) Retaining ring nut
- K) Inlet shutoff valve (system-side connection)
- L) Outlet shutoff valve (boiler-side connection)
- M) Cap
- N) Dual wrench
- O) Brass inlet/outlet tee (only for DF110 and DF120 models)
- P) Lead seal (optional)

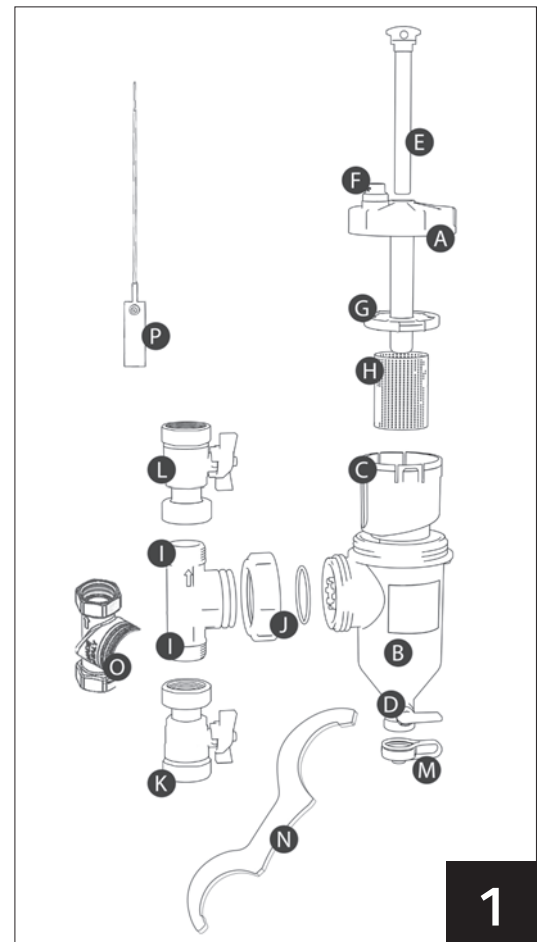

FOR PLUMBERS: INSTALLATION

Before installing in a new system, the pipelines should be flushed to remove any dirt or waste. Before installation in an existing system, clean the system and then carry out a filmforming treatment. Install DirtOUT® XL near the boiler, on the heating system return line:

1. DirtOUT® XL must be installed with the drainage valve D facing downwards.
2. The inlet and outlet pipes may be vertical, horizontal or at a 45° angle. To change the orientation of the connections, completely unscrew the retaining ring nut J using the dual wrench N supplied with the product, disconnect the body B and reposition the connections I in the required angle.

Screw the retaining ring nut J back on and tighten.

3. Unscrew the screw on the air vent F to bleed off any air trapped in the product.
4. DirtOUT® XL is supplied with a 500 µm mesh strainer fitted.
This strainer is particularly suited to the flow of the system and the first month of operation.

It can subsequently be replaced with the 800 µm mesh strainer included in the package.



- Top plug tightening torque: from 8 to 10 Nm
- Adjustable tee ring tightening torque: from 8 to 10 Nm
- Tightening torque of the shut-off valves (when provided): from 6 to 8 Nm

BY-PASS ADJUSTMENT (see fig. 2)

Only for code DF00120114 (1" ¼) it is possible to reduce the flow rate passing through the device, from the minimum flow rate in START mode to the maximum flow rate in ECO mode.





FOR PLUMBERS/SYSTEM OWNERS:

MAINTENANCE

The quantity of waste that accumulates in DirtOUT® XL depends on the condition of the system. Perform ROUTINE CLEANING and SPECIAL CLEANING operations in observance of the specified schedules.

ROUTINE CLEANING

Perform routine cleaning every three months during the heating season.

Procedure:

1. Turn off the boiler and ensure that the system water is at ambient temperature*.
2. Note the system operating pressure as indicated on the boiler gauge*.
3. Remove the lead seal P (optional) and extract the magnet E from the upper cover A and remove it completely.
4. Close the inlet shut-off valve (system side), alternatively make sure to shut off the water using suitable shut-off tools, before it enters the DirtOUT® XL.
5. Unscrew the cap M and place a bucket underneath it.
6. Open the drainage valve D for 2-3 seconds, close again and then wait a few seconds. Repeat this operation a second time.
7. Reinstall the cap M.
8. Replace the magnet E . Optionally: replace the lead seal P.
9. Restart the system, restoring the pressure noted in step 2*.

SPECIAL CLEANING - MESH STRAINER REPLACEMENT

Perform the special cleaning procedure at least once a year.

Procedure:

1. Turn off the boiler and ensure that the system water is at ambient temperature*.
2. Note the system operating pressure as indicated on the boiler gauge*.
3. Close the shut-off valves K and L to cut off the portion of the system where DirtOUT® XL is installed, alternatively cut off the portion of the system where DirtOUT® XL is installed using suitable shut-off tools.
4. Remove the lead seal P (optional) and extract the magnet E from the upper cover A and remove it completely.
5. Unscrew the upper cover A using the dual wrench N included with the product.
6. Unscrew the retaining ring nut J . Disconnect DirtOUT® XL from the system.
7. Rinse the mesh strainer H and all other components under running water.

8. Reinsert the cyclonic insert C , the required mesh strainer H and the mesh strainer support G in the body.
9. Close the upper cover and reconnect DirtOUT® XL to the inlet/ outlet connections I , screwing down the retaining ring nut J.
10. Replace the magnet E . Optionally: replace the lead seal P.
11. Ensure that the drainage valve D is closed.
12. Reopen the shut-off valves K and L, alternatively reconnect the portion of the system where DirtOUT® XL is installed using suitable shut-off tools.
13. Restart the system, restoring the pressure noted in step 2*.

*Note: consult the operation and maintenance manual of the boiler if necessary.

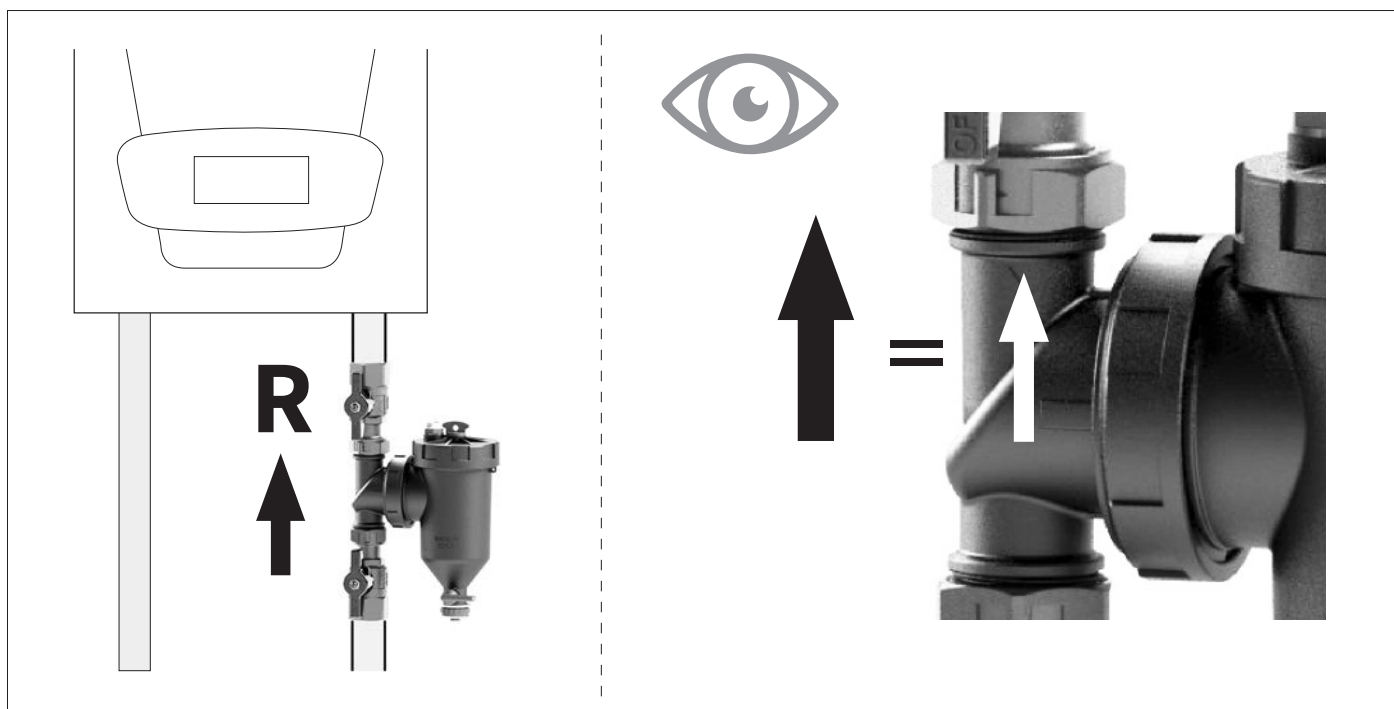

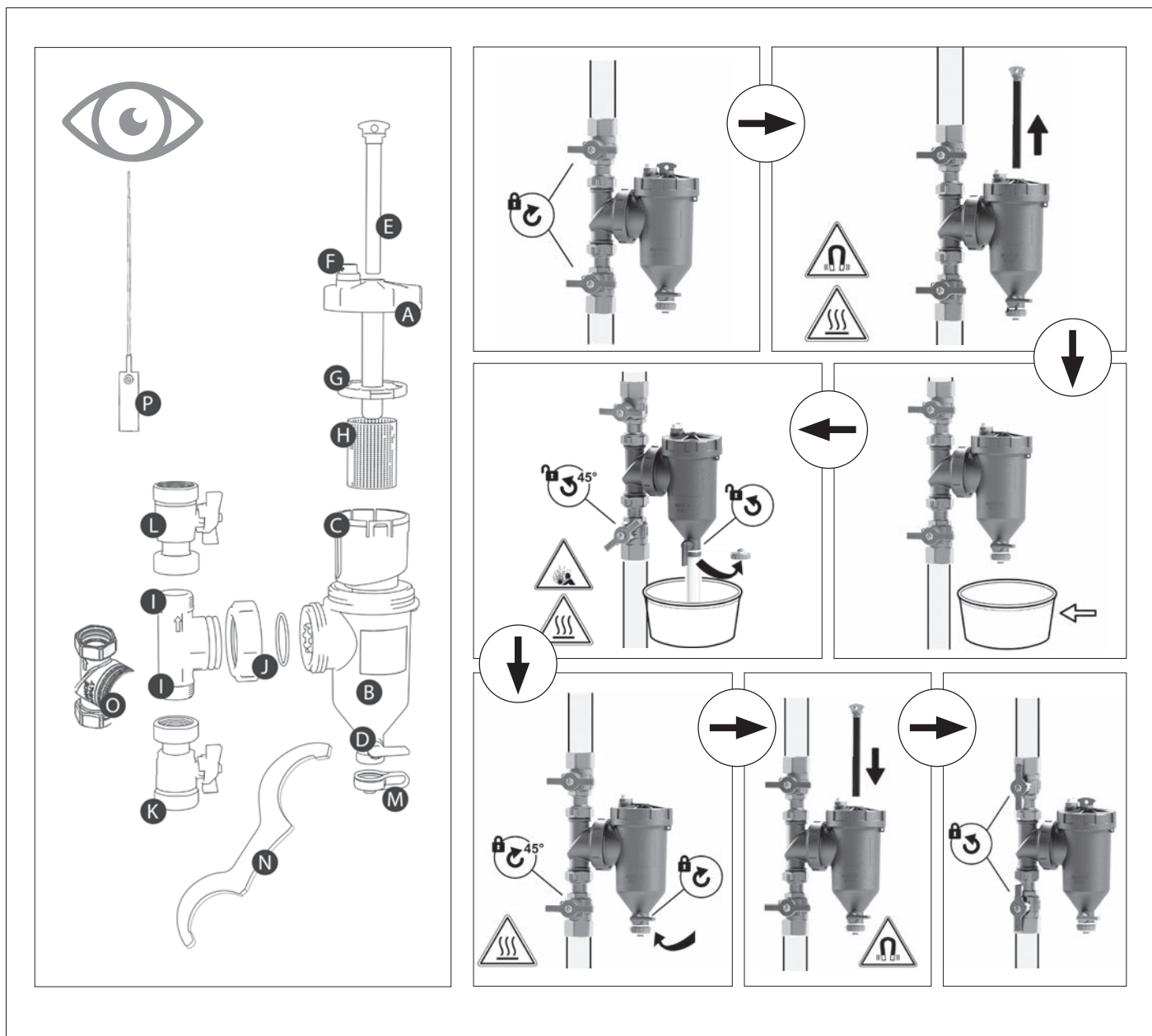

WARRANTY

The magnetic dirt separator is guaranteed for 2 years from the date of purchase. The warranty does not cover malfunctions due to failure to observe the instructions in this manual.



ENVIRONMENT

The product must be disposed of in accordance with local regulations.

TECHNICAL DATA

Maximum operating pressure	3 bar
Temperature	0 - 90 °C
Magnete	Neodymium, magnetic induction B=1,4T(14.000G)
Mesh strainer	800 µm in stainless steel AISI 304 500 µm in AISI 304 stainless steel for initial system cleaning (pre-installed)
Compatible fluids	Water or glycol solution (max. 50%)
Flow factor Kv	With ball valve: DF00100022 m ³ /h 6,4 DF00100028 m ³ /h 6,7 DF00100034 m ³ /h 6,4 DF00100100 m ³ /h 6,7 DF00100114 m ³ /h 6,9 Without ball valve: DF00110034 m ³ /h 6,6 DF00110100 m ³ /h 6,9 DF00110022 m ³ /h 6,6 DF00110028 m ³ /h 6,9 DF00120114 m ³ /h 7,4 min ÷ 15,1 max
Containment capacity	400 ml
Connections	With ball valve: ø 22 x ø 22 Copper pipe (DF00100022) ø 28 x ø 28 Copper pipe (DF00100028) ¾" F x ¾" F (DF00100034) 1" F x 1" F (DF00100100) 1¼" F x 1¼" F (DF00100114) Without ball valve: ¾" F x ¾" F (DF00110034) 1" F x 1" F (DF00110100) ø 22 x ø 22 Copper pipe (DF00110022) ø 28 x ø 28 Copper pipe (DF00110028) 1¼" F x 1¼" F (DF00120114)